



ARCHITECTURAL TRIM AND MOLDINGS





Architectural Trim & Moldings

Often, it's the subtle touches that make the biggest impact. With Stylmark's Trim Maker®, you can easily add accent to walls, ceilings, soffits and columns, or provide a smooth transition between planes. Installation is simple. Just secure the base and snap the trim into place.

Trim Maker is available in hundreds of shapes, colors and finish combinations. You can also group shapes to create your own look or work with our engineers to design a shape that's perfect for your unique application.

Curving	2
About Trim Maker®	3
Installation	4
Quarter Rounds	5
Half Rounds	6
Rectangulars	8
Special Shapes	10
Bases	12

Curving

Bring it all together with a few carefully placed curves. Stylmark is able to curve virtually all of our products to meet your radius requirements. Simply provide us with dimensions as indicated below and watch your design come to life!

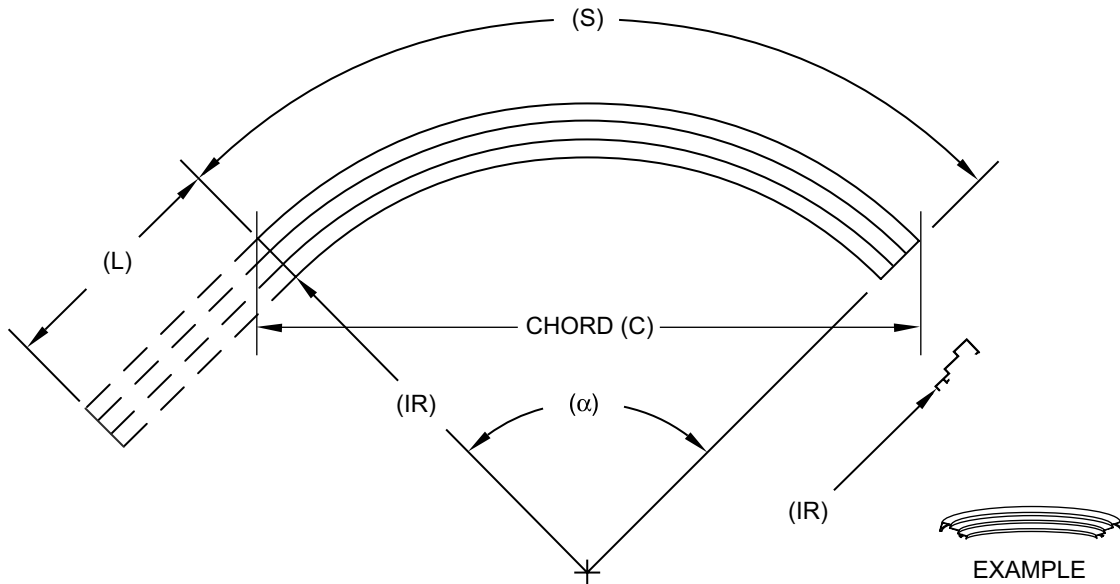

Required Information:

- Trim Maker part number
- Orientation of part to be curved
- Radius (IR)
- Arc Length (S)
- Chord (c) or Included Angle (α)
- Straight Length (L)

Notes:

- Customer templates are not required
- Provide AutoCAD® or SolidWorks drawing if available
- For architectural trim applications, mount plates may need to be sectioned to accommodate the radius
- The maximum amount of usable material per 3657.6mm length after curving is 2473.2mm

Trim Maker®

Trim Maker is easy to order. Simply select the trim shape and accompanying base that best fits your requirements. Next calculate the amount of material you need (overall length) and determine the number of 3657.6mm stock lengths required.

When your application of Trim Maker leaves an outside edge exposed, endcaps may be inserted to give the trim a more finished appearance. Most shapes have a matching left hand and right hand endcap available. Endcaps are designed to install by sliding their tabs into the base, or by siliconing the endcap to the end of the trim.

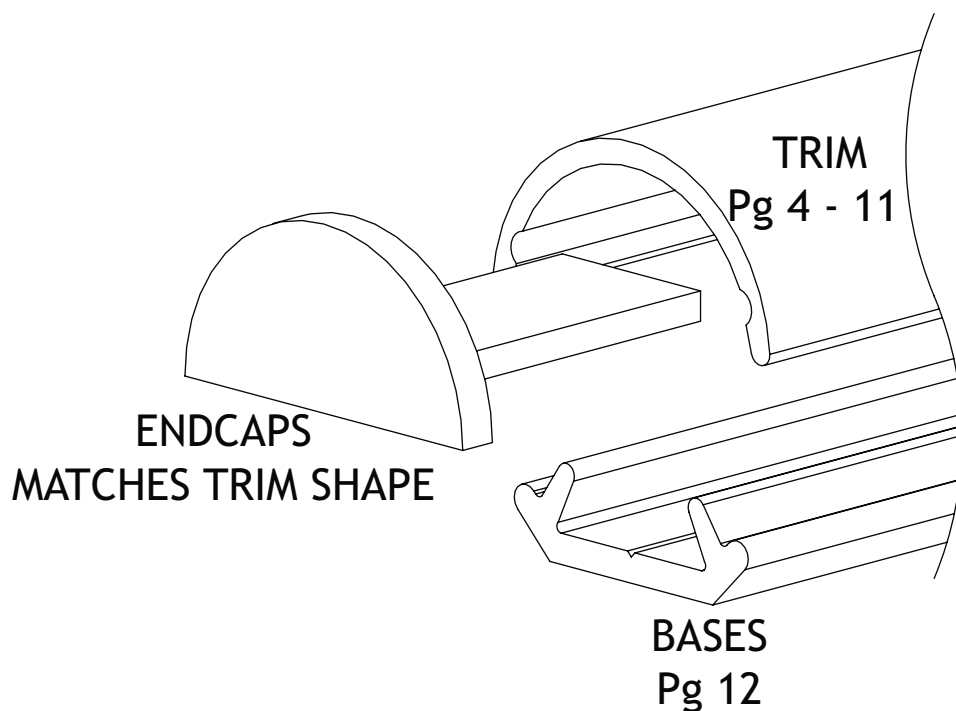

Installation

Trim Maker installs in two easy steps, as shown here:

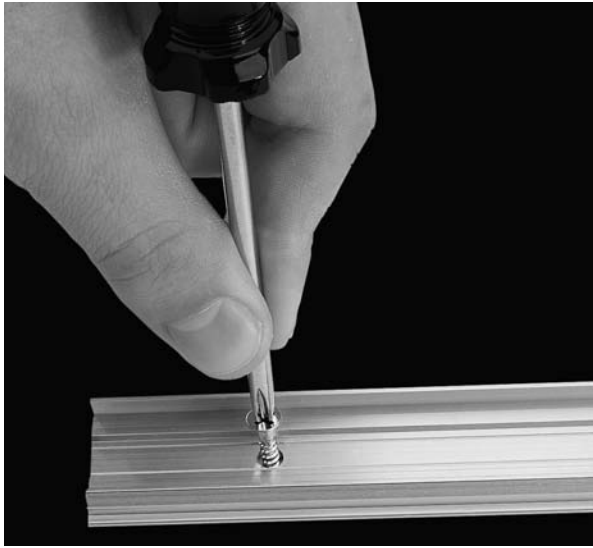

1. Mount the necessary length of base in the desired location by driving fasteners through pre-punched mounting holes.

2. Align the Trim Maker extrusion to the catch rails of the base and press it into a secure position.

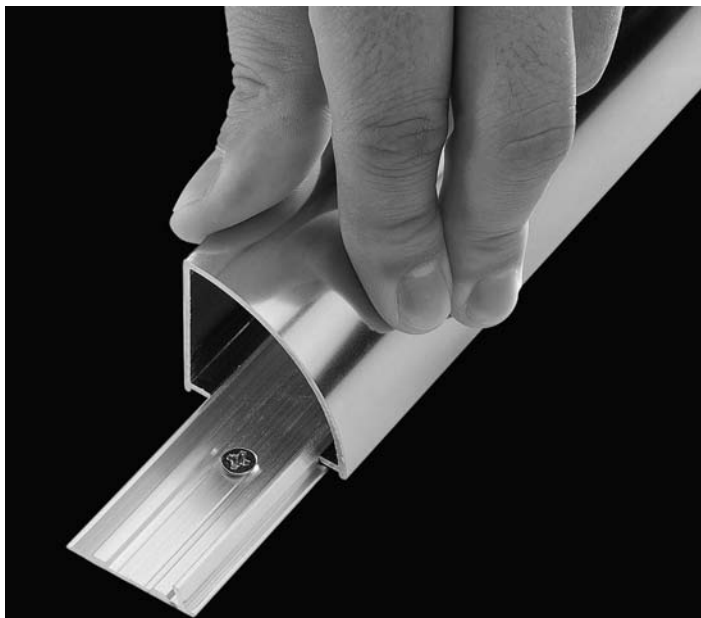

Reference Installation Bulletin #971222 for instructions.

Quarter Rounds

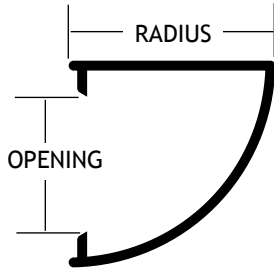

PART #	RADIUS	OPENING	BASE NUMBER(S)	ENDCAP RH	ENDCAP LH
110152	101.6	-	110333 or 410616	510186 ASSEMBLY	
110286	76.2	50.8	410540	310239	310242
110290	38.1	25.4	410443	310240	310243
110296	19.1	15.9	411331	310375	310374
110299	31.8	17.5	410530	310244	310245
110308	50.8	25.4	410443	310252	310253
110309	63.5	50.8	410540	310254	310255
110561	57.2	25.4	410443	-	-
110562	44.5	25.4	410443	-	-

Part # 110152

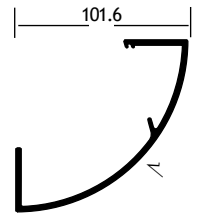

Base: 110333 or 410616
Endcap Assembly: 510186

Part # 110286

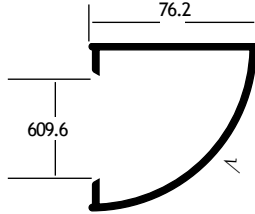

Base: 410540
Endcaps: RH 310239, LH 310242

Part # 110290

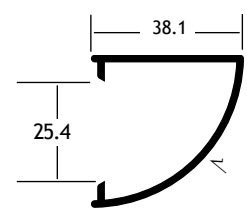

Base: 410443
Endcaps: RH 310240, LH 310243

Part # 110296

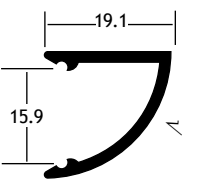

Base: 411331
Endcaps: RH 310375, LH 310374

Part # 110299

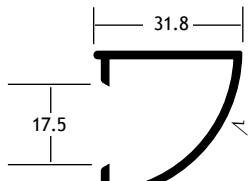

Base: 410530
Endcaps: RH 310244, LH 310245

Part # 110308

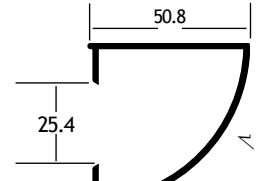

Base: 410443,
Endcaps: RH 310252, LH 310253

Part # 110309

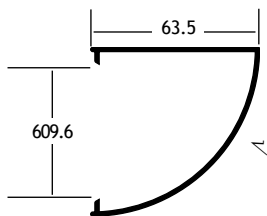

Base: 410540
Endcaps: RH 310254, LH 310255

Part # 110561

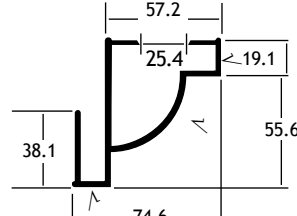

Base: 410443
Endcap: n/a

Part # 110562

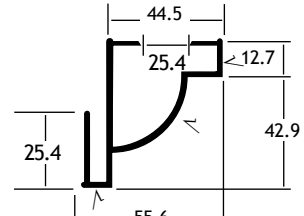

Base: 410443
Endcap: n/a

Notes:

- Part #110152 utilizes a slide-in base or mount bracket.
- Stylmark's anodized finishes are not recommended for outdoor applications.

√ = finished surface
Drawings are not to scale

Half Rounds

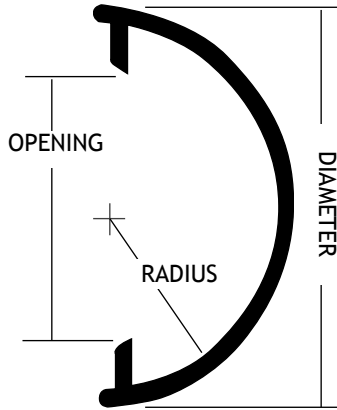

PART #	RADIUS	DIAMETER	OPENING	BASE NUMBER(S)	ENDCAP NUMBER
110200	19.1	38.1	25.4	410443, 410466	310204
110201	25.4	50.8	25.4	410443, 410466	310205
110202	38.1	76.2	50.8	410540	310206
110210	50.8	101.6	76.2	410458	310207
110211	63.5	127.0	114.3	412002	310208
110212	76.2	152.4	114.3	412002	310209
110267	9.5	19.1	15.9	411331	310395
110285	57.2	114.3	76.2	410458	310238
110295	25.4	50.8	25.4	410443	310205
110310	31.8	63.5	50.8	410540	310249
110328	12.7	25.4	15.9	411331	310323
110355	38.1	76.2	66.7	-	-
110507	15.9	31.8	17.5	410530, 411185	-

Part # 110200

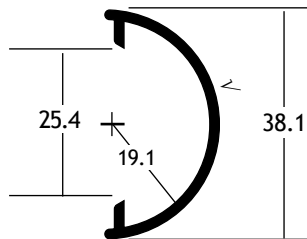

Base: 410443, 410466
Endcap: 310204

Part # 110201

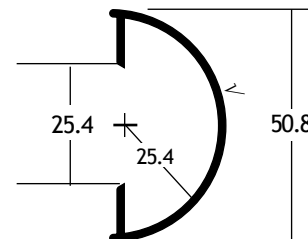

Base: 410443, 410466
Endcap: 310205

Part # 110202

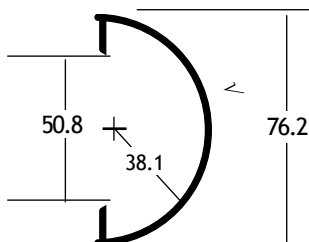

Base: 410540
Endcap: 310206

Part # 110210

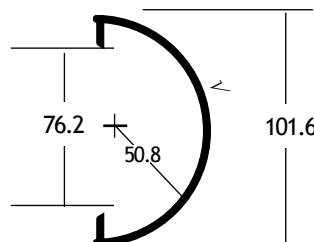

Base: 410458
Endcap: 310207

Part # 110211

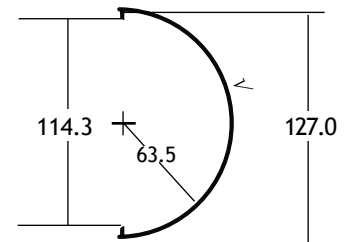

Base: 412002
Endcap: 310208

√ = finished surface
Drawings are not to scale

Half Rounds

Part # 110212

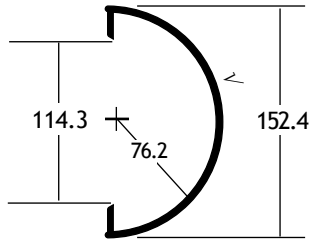

Base: 412002
Endcap: 310209

Part # 110267

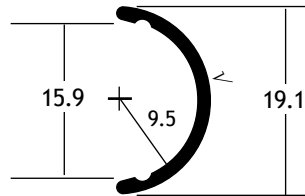

Base: 411331
Endcap: 310395

Part # 110285

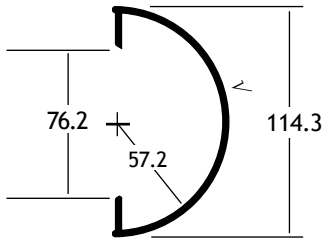

Base: 410458
Endcap: 310238

Part # 110295

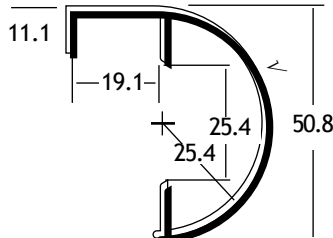

Base: 410443
Endcap: 310205

Part # 110310

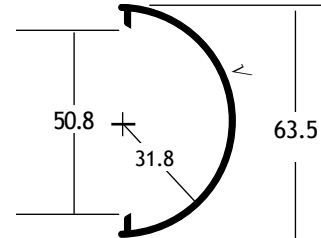

Base: 410540
Endcap: 310249

Part # 110328

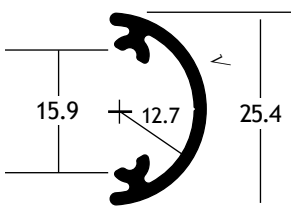

Base: 411331
Endcap: 310323

Part # 110355*

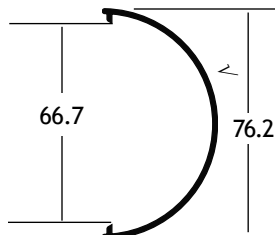

Base: n/a
Endcap: n/a

Part # 110507

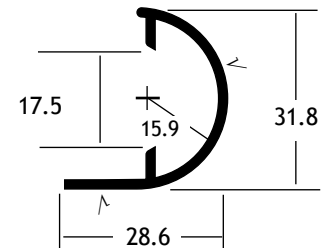

Base: 410530, 411185 (recessed)
Endcap: n/a

- Notes:
- Stylmark's anodized finishes are not recommended for outdoor applications.
 - Part # 110355 is special order only.

√ = finished surface
Drawings are not to scale

Rectangulars

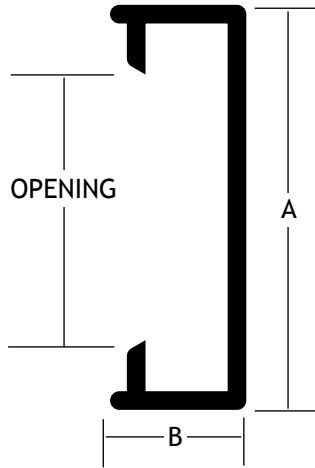

PART #	A	B	OPENING	BASE NUMBER(S)	ENDCAP NUMBER
110223	34.7	8.3	25.4	410443, 410466	310212
110225	38.1	12.7	25.4	410443, 410466	310213
110226	76.2	19.1	50.8	410540	310214
110227	101.6	19.1	76.2	410458*	310215
110232	101.6	50.8	76.2	410458	310218
110245	76.2	38.1	50.8	410540	310229
110248	25.4	12.7	15.9	411331	-
110260	127.0	19.1	114.3	412002	-
110269	152.4	19.1	114.3	412002	310235
110294	38.1	12.7	25.4	410443, 410466	310241
110304	57.2	12.7	25.4	410443, 410466	310251
110307	50.8	15.9	25.4	410443, 410466	310250
110410	19.1	19.1	15.9	411331	310403
110639	50.8	25.4	25.4	410443, 410466	-
110672	19.1	4.8	16.7	412007	-

Part # 110223

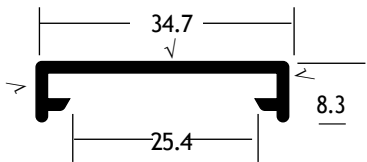

Base: 410443, 410466
Endcap: 310212

Part # 110225

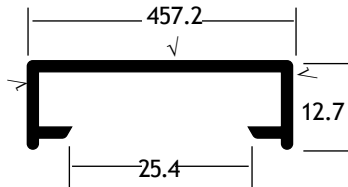

Base: 410443, 410466
Endcap: 310213

Part # 110226

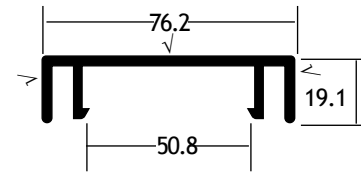

Base: 410540
Endcap: 310214

Part # 110227

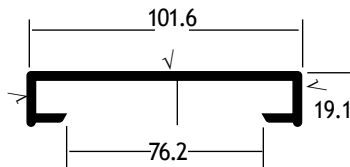

Base: 410458
Endcap: 310215

Part # 110232

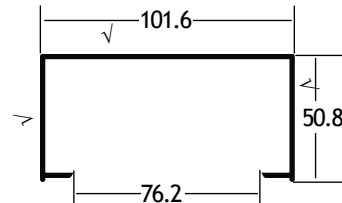

Base: 410458
Endcap: 310218

√ = finished surface
Drawings are not to scale

Rectangulars

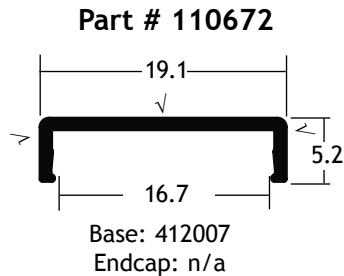
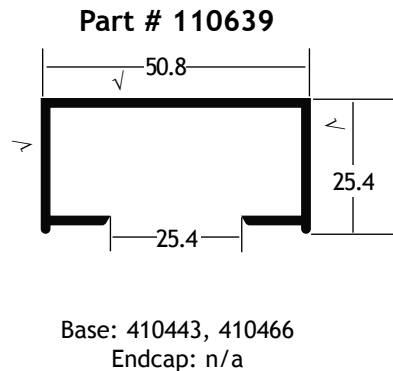
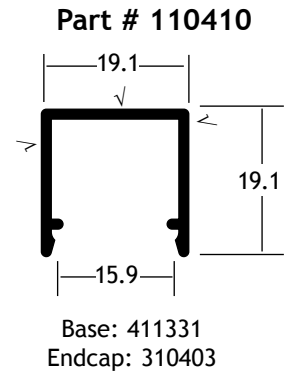
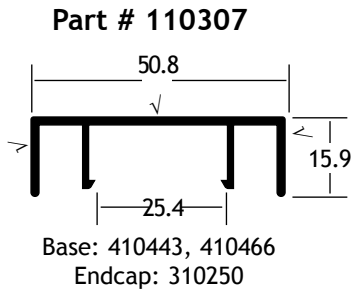
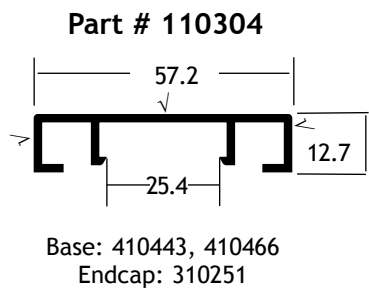
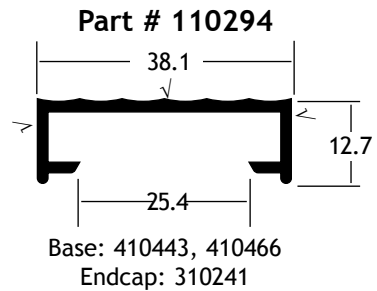
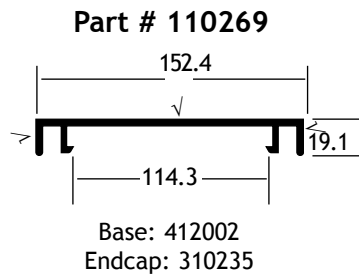
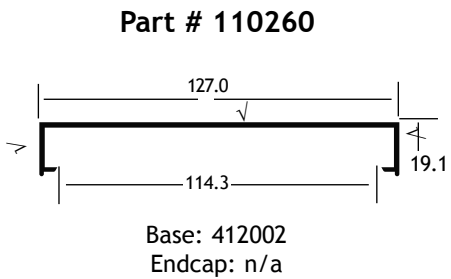
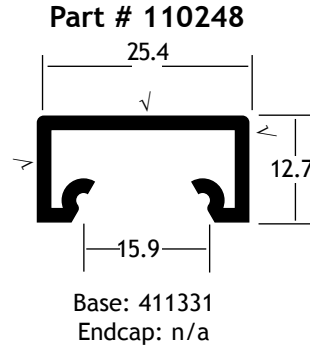
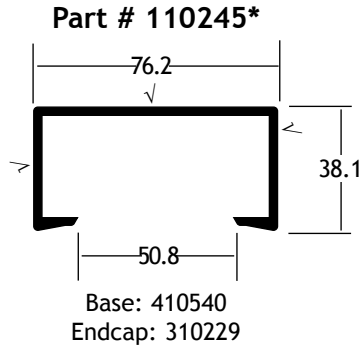

✓ = finished surface
Drawings are not to scale

- Notes:
- Stylmark's anodized finishes are not recommended for outdoor applications.
 - Part #110245 is special order only

Special Shapes

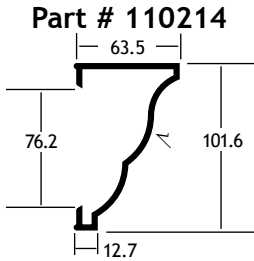

Base: 410458
Endcaps: RH 310210, LH 310211

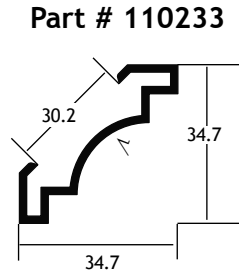

Base: 410443
Endcaps: 310219

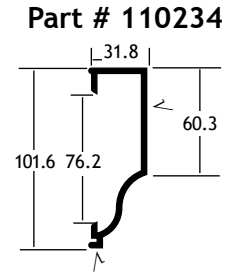

Base: 410458
Endcaps: RH 310221, LH 310220

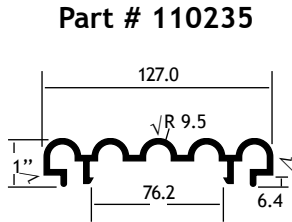

Base: 410458
Endcap: 310222

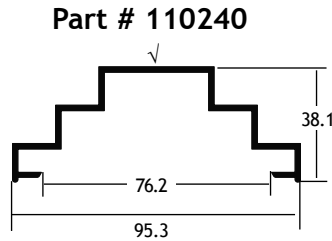

Base: 410458
Endcaps: 310225

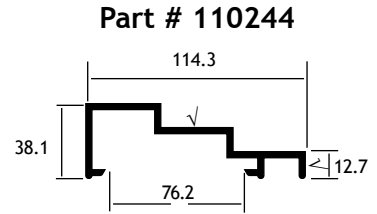

Base: 410458
Endcaps: RH 310228, LH 310227

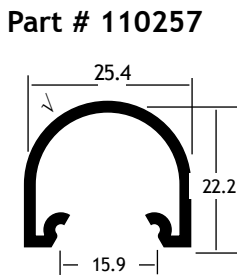

Base: 411331
Endcap: 411298

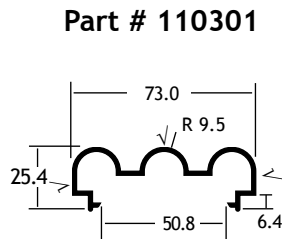

Base: 410540
Endcap: 310246

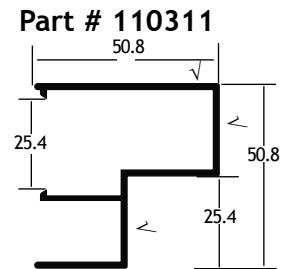

Base: 410443
Endcaps: RH 310247, LH 310256

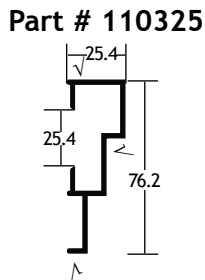

Base: 410443
Endcap: RH 310260, LH 310259

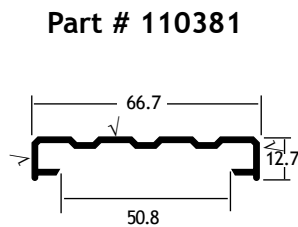

Base: 410540
Endcap: 310286

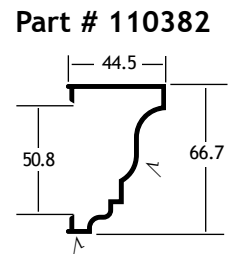

Base: 410540
Endcaps: RH 310288, LH 310287

∩ = finished surface
Drawings are not to scale

Special Shapes

Part # 110383

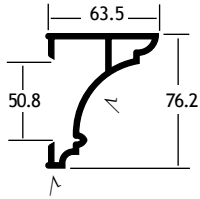

Base: 410540
Endcaps: RH 310293, LH 310292

Part # 110384

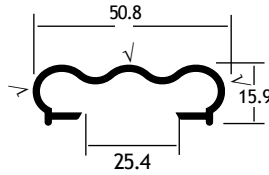

Base: 410443
Endcap: 310289

Part # 110385

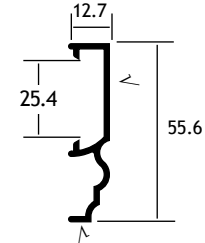

Base: 410443
Endcaps: RH 310291, LH 310290

Part # 110400

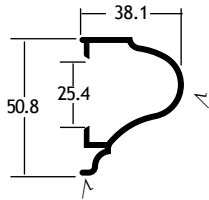

Base: 410443
Endcaps: RH 310385, LH 310386

Part # 110416

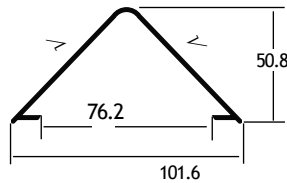

Base: 410458
Endcap: n/a

Part # 110420

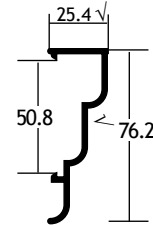

Base: 410540
Endcaps: RH 310378, LH 310377

Part # 110424

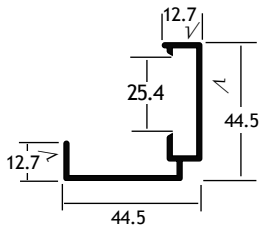

Base: 410443
Endcap: n/a

Part # 110465

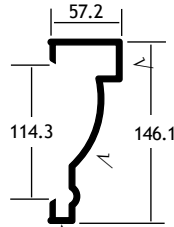

Base: 412002
Endcaps: RH 310400, LH 310399

Part # 110617

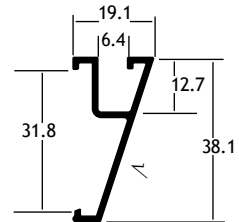

Base: 110618
Endcap: n/a

Part # 110740

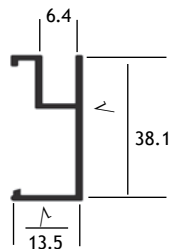

Part # 110741

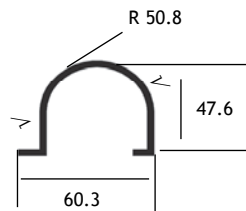

√ = finished surface
Drawings are not to scale

Notes: • Stylmark's anodized finishes are not recommended for outdoor applications.

Bases

Part # 110333

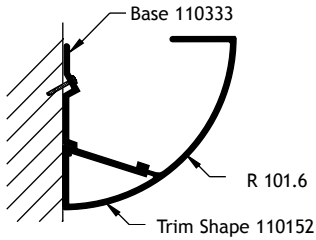

Part # 110618

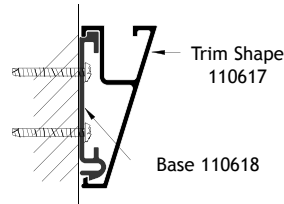

Part # 410443

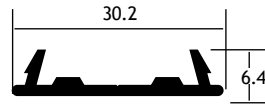

Part # 410458

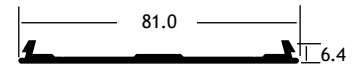

Part # 410466

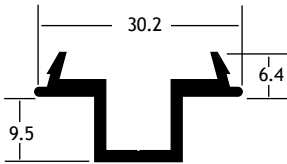

Part # 410530



Part # 410540

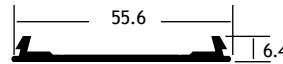

Part # 410644

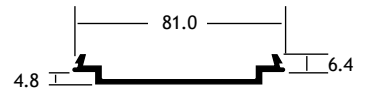

Part # 410658

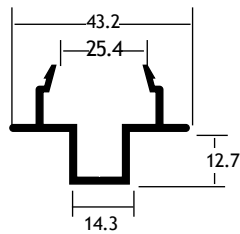

Part # 410696

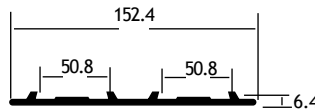

Part # 410697

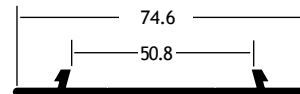

Part # 411185

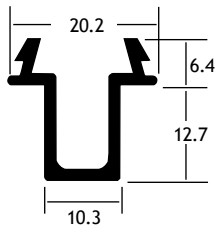

Part # 411331

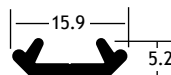

Part # 412002

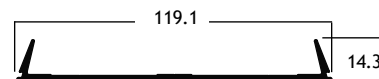

Part # 412007

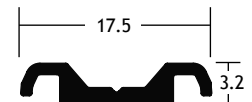

Drawings are not to scale

Notes: • Part #110333 also available as a 76.2mm mount bracket (Part #410616).



Flexible • Collaborative • Transformative • Solutions

For companies that need more than “just the components”,
Stylmark is a versatile manufacturer that creates the
spectrum of essential elements - to create comprehensive
and distinctive lifestyle environments.

Architectural Trim & Moldings
Backlit Displays & Transparency Frames
Complete Solutions & Specialty Fixtures
Fitting Room Systems & Mirror Kits
Framing & Partition Systems
Hardware & Accessories
Shelving
Showcases



Inside Aluminium
Sandhill Barn
Sandhill Lane
Washington
West Sussex,
RH20 4TD
00 44 (0) 1903 893992
info@insidealuminium.com
www.insidealuminium.com

